

DESIGN GUIDELINES BOUNDARIES

HIGHER DENSITY

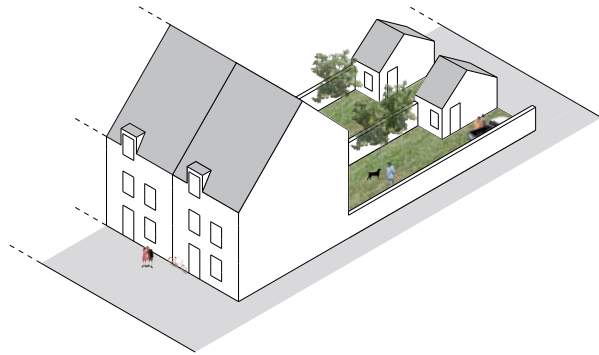

Higher density backyards to backyards and side streets to backyards would be separated by walls the same as the building walls or a hedge (including a post and wire fence or double fence).

Max 3.5 stories, 18 m to ridge.

MEDIUM DENSITY



Medium density backyards would be sheltered from the streets by hedges with high post and wire fences or walls the same as building walls. The plots would be separated at the rear by hedges and biostrips.

Max 2.5 stories, 15 m to ridge.

LOWER DENSITY

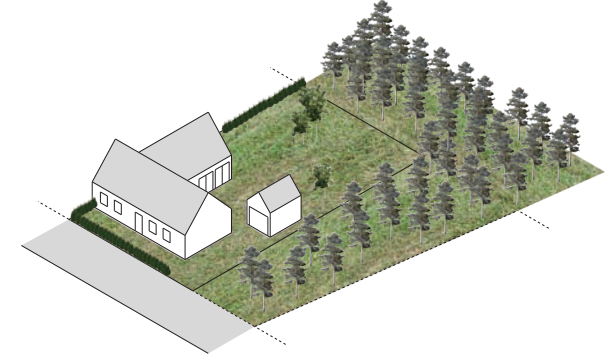

Lower density plots would be separated from each other by post and wire fences with hedges or remain open. The interface with the landscape would be a woodland edge which in some places expands into wedges between the plots, bringing the forest into the built fabric.

Max 2 stories, 10 m to ridge.