

## SPACES FOR RECREATION & PLAY

Distributed throughout the new settlement, places for organized and informal recreation would be close at hand to homes, institutions and workplaces. These would be in a range of scales to accommodate the different requirements of play and recreation for young and old. In particular, the different kinds of play for children as they grow would be carefully considered. Encouraging outside play and activity would be an important aspect for the health and well-being of the inhabitants.

### LOCAL AREA PLAYGROUND (LAP)

Would be provided in small areas at frequent intervals, where they can be easily watched and supervised, suitable for children.

### LOCAL EQUIPPED AREA PLAYGROUND (LEAP)

Would be provided at convenient locations, suitable for youngsters.

### NEIGHBOURHOOD EQUIPPED AREA PLAYGROUND (NEAP)

Suitable for a wider range of users including teenagers, these would have access to the bus route. These would include the school grounds, soft-landscaped spaces in the Big Green and in the Spey Park and possibly some hard-landscaped spaces within the High Street. Their design would avoid nuisance from noise.

### PLAYING FIELDS

Conventional playing fields for organised games, team sports and noisier activities are placed on the edge of the community, close to the area which is intended to become the Countryside Park.

### INFORMAL RECREATION

The network of paths through and around An Camas Mòr would connect with the excellent environment and facilities that Rothiemurchus and the Cairngorms are well known for.

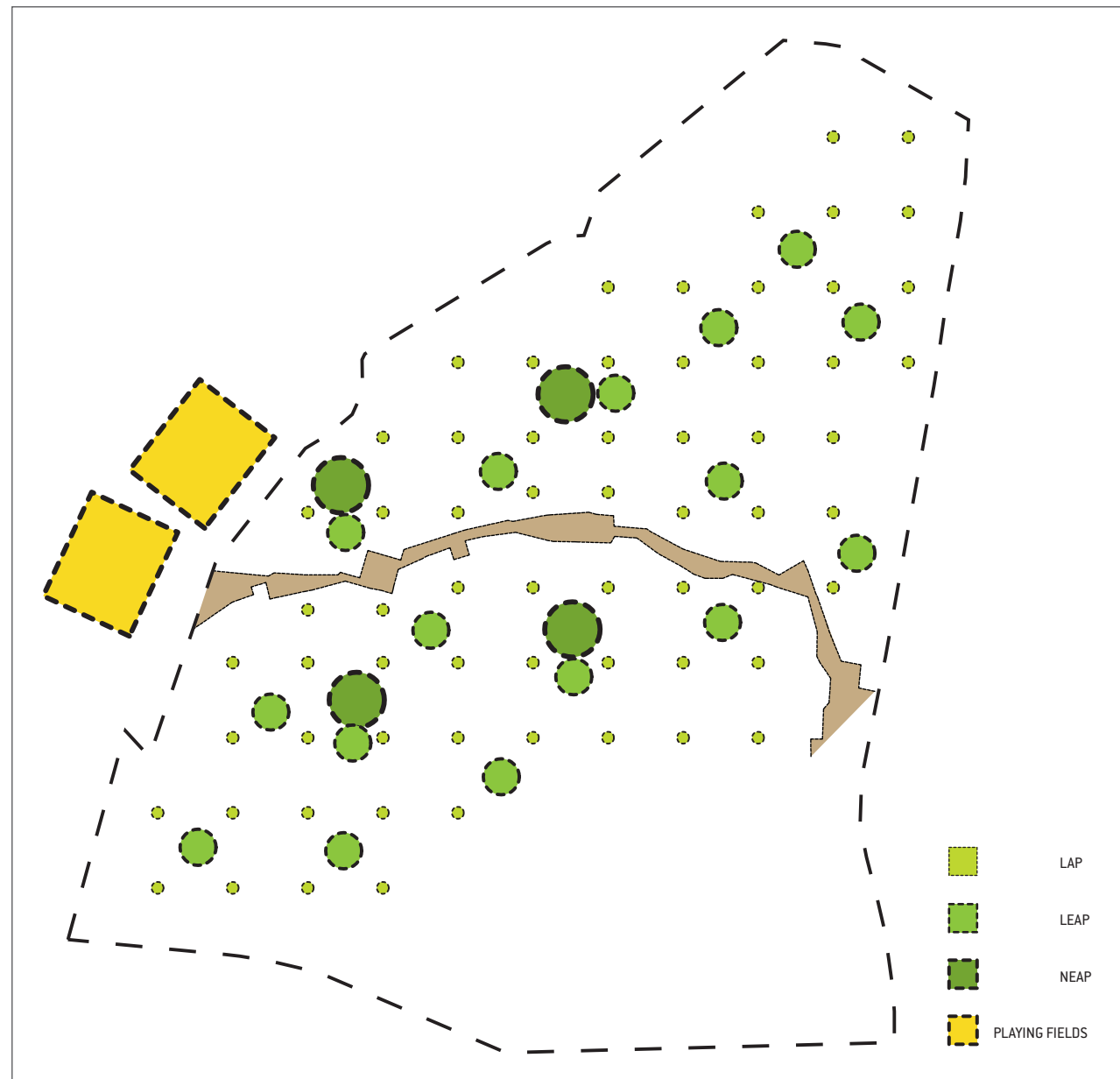

## SPACES FOR RECREATION & PLAY



### Big Green

The undulating topography of the northern part of the site includes one much larger oval-shaped former kettlehole which currently includes open space as well as vegetation. We have called the space 'The Big Green' and considered it as a town park, which could accommodate mainly informal play and recreation. Robust and slightly wild in character, it would include some play equipment, ideally incorporated into the landscape. The Big Green would also be a suitable place to accommodate the popular local activity, bouldering.



### Circus

Preserving the remarkably perfect circular hollow and its trees, the Circus would have a more formal character than the 'Big Green'. A more genteel and tranquil place, for passive recreation, it would include a good number of benches, well-placed to benefit from the sun.



### Local Play

Never more than a minute away, these would be small multi-functional landscaped spaces. Ideally each space would be unique with some planting, a bench for parental supervision and a 'play focus', such as a large rock, a piece of art or a landscape feature. Some places would also include smaller play equipment such as a sand-pit, swings, chute, etc. These places would be closely situated to surrounding dwellings, and would be well over-looked from neighbouring properties.



### Neighbourhood Play

These would be local attractions, key places where children from throughout the community might meet. These would include larger and more specialised equipment such as climbing frames or bouldering.

These might also include some hard landscaping to cope with greater intensity of use. These places would be over-looked while at the same time offering some buffering to their immediate surroundings; and perhaps situated by the playing fields.

